

ResMed

AirFit™ P30i



A new tube-up option

ResMed AirFit™ P30i offers a nasal pillows cushion option for patients who prefer a top-of-the-head tube design. Just like AirFit N30i, it features a SpringFit frame designed to adapt to each patient's face and only two frame sizes, which streamlines fitting and SKU management.

 **MultiDoctorShop**
Medical products at home

We provide the official
document of the manufacturer

www.multidoctorshop.com



ResMed.com/AirFitP30i

AirFit P30i highlights

Quick-release elbow

allows for easy disconnection. The pinch-clip elbow stays attached to the tubing to ensure parts do not get stuck or lost.

SpringFit frame

automatically adjusts to different facial profiles, helping provide an accurate fit the first time.

Top-of-head design gives patients the freedom to sleep in any position and closer to their bed partner.

Soft sleeves designed for added comfort and reduction in facial marks.

Nasal pillows cushion

is interchangeable with AirFit N30i nasal cradle cushion.

QuietAir™ vent breaks up exhaled air for a quiet experience that is less disruptive to the bed partner.



AirFit P30i product codes

Complete mask systems (includes frame system, headgear and 2 more cushion sizes)	Product code
AirFit P30i STPK AMER – STD	63850
AirFit P30i STPK AMER – SML	63851
Airfit P30i Sleep Lab Mask STPK – STD	63871
Airfit P30i Sleep Lab Mask STPK – SML	63872
Frame systems (includes frame, cushion and elbow)	
AirFit P30i STD Frame Sys – L	63852
AirFit P30i SML Frame Sys – L	63853
AirFit P30i STD Frame Sys – M	63854
AirFit P30i SML Frame Sys – M	63855
AirFit P30i STD Frame Sys – S	63856
AirFit P30i SML Frame Sys – S	63857

Accessories	Product code
AirFit P30i Pillow – S	63861
AirFit P30i Pillow – M	63862
AirFit P30i Pillow – L	63863
AirFit 30i Headgear	63814

AirFit P30i vs. DreamWear Gel Pillows

In a recent study, a majority of patients preferred AirFit P30i to DreamWear™ Gel Pillows for overall performance. Of those with a preference, more than 70% found that it sealed better and 66% found it easier to use.¹

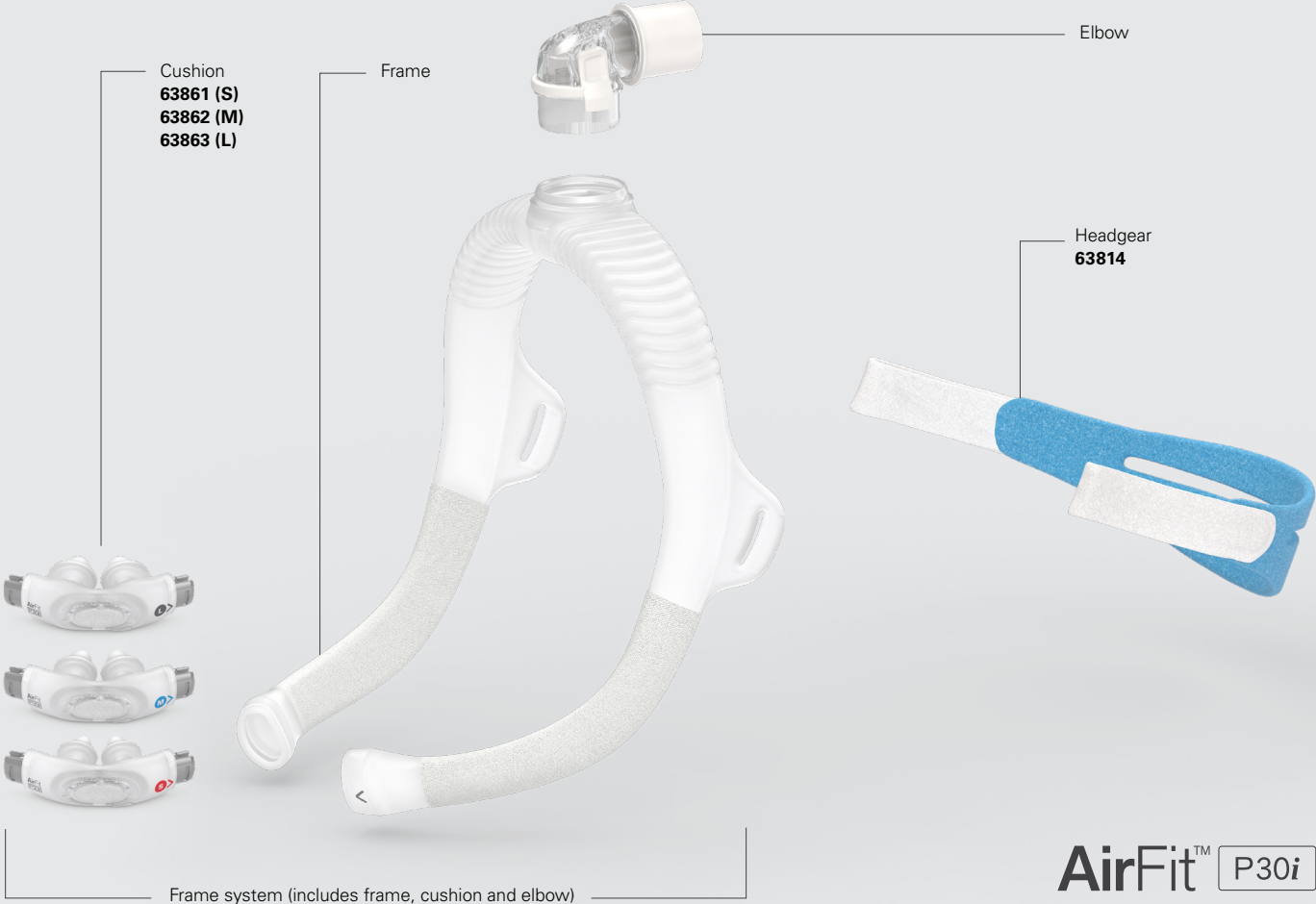

AirFit™ P30i
Nasal pillows mask

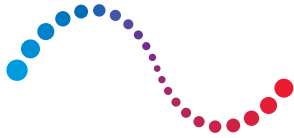

ResMed

AirFit™ P30i

Fitting guide for AirFit P30i



- Pull the frame and headgear over the head until the elbow is positioned on top and the headgear is behind the head.



- Place the cushion under the nose and align the pillows into the nostrils.



- Tighten or loosen the headgear until the cushion fits comfortably under the nose.



- Squeeze the side buttons on the elbow and detach from the frame. Connect the air tubing from the device to the elbow, then reattach to the frame.

Additional options

For patients with longer hair, we recommend feeding their hair through the back of the headgear. If tied in a pony tail, it should sit high enough to fit comfortably through the back of the headgear.

Refer to the user guide for further instructions and complete labeling information including indications, contraindications, warnings and precautions.

1 ResMed guided external clinical study of 23 current nasal pillows mask users from May to June, 2018 in Sydney, Australia who trialed ResMed AirFit P30i and Phillips™ Resprionics DreamWear gel pillows. One participant withdrew consent after study completion (n=22).

Distributed by ResMed Corp, 9001 Spectrum Center Boulevard, San Diego, CA 92123 USA +1 858 836 5000 or 1 800 424 0737 (toll free). See ResMed.com for other ResMed locations worldwide. AirFit is a trademark and/or registered trademark of the ResMed family of companies. DreamWear and Phillips are trademarks of Koninklijke Philips N.V, registered in the US and other countries. Specifications may change without notice. For patent and other intellectual property information, see ResMed.com/ip. © 2019 ResMed. 10111097/1 2019-01

[ResMed.com/AirFitP30i](https://www.resmed.com/AirFitP30i)